

09/08/2019

See Sheet 1A For Index of Sheets

STATE OF NORTH CAROLINA
DIVISION OF HIGHWAYS

**BUFFER DRAWING
SHEET 1 OF 3**

STATE	STATE PROJECT REFERENCE NO.	SHEET NO.	TOTAL SHEETS
N.C.	BP2.R020	1	
STATE PROJ. NO.	F.A. PROJ. NO.	DESCRIPTION	
BP2.R020.1		P.E.	
BP2.R020.2		RW & UTIL.	

TIP PROJECT: BP2.R020

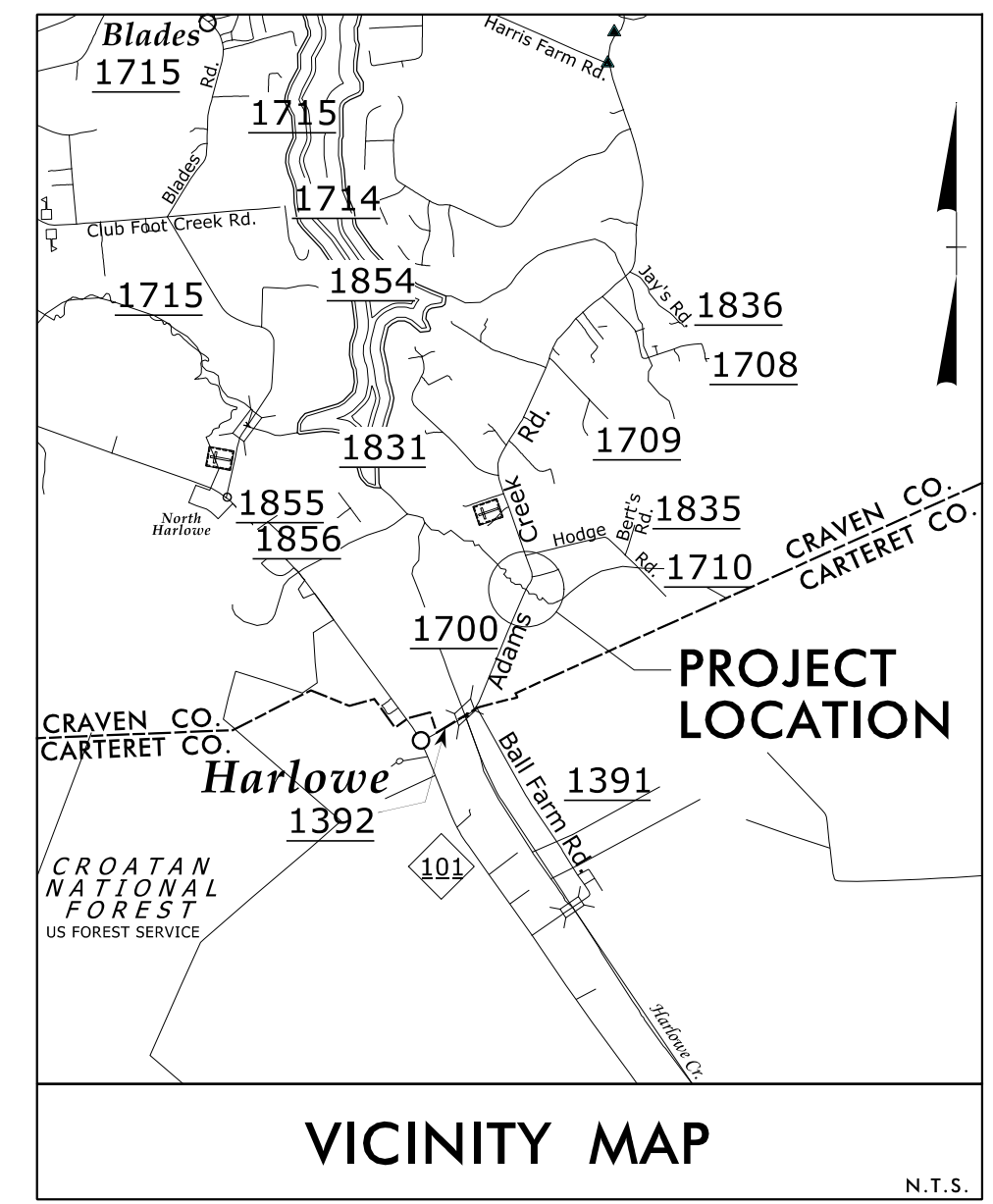

75% PLAN SUBMITTAL

CRAVEN COUNTY

LOCATION: CULVERT ON SR 1700 (ADAMS CREEK RD.) OVER CLUB FOOT CREEK
TYPE OF WORK: DRAINAGE, GRADING, PAVING, & CULVERT

BUFFER IMPACTS PERMIT

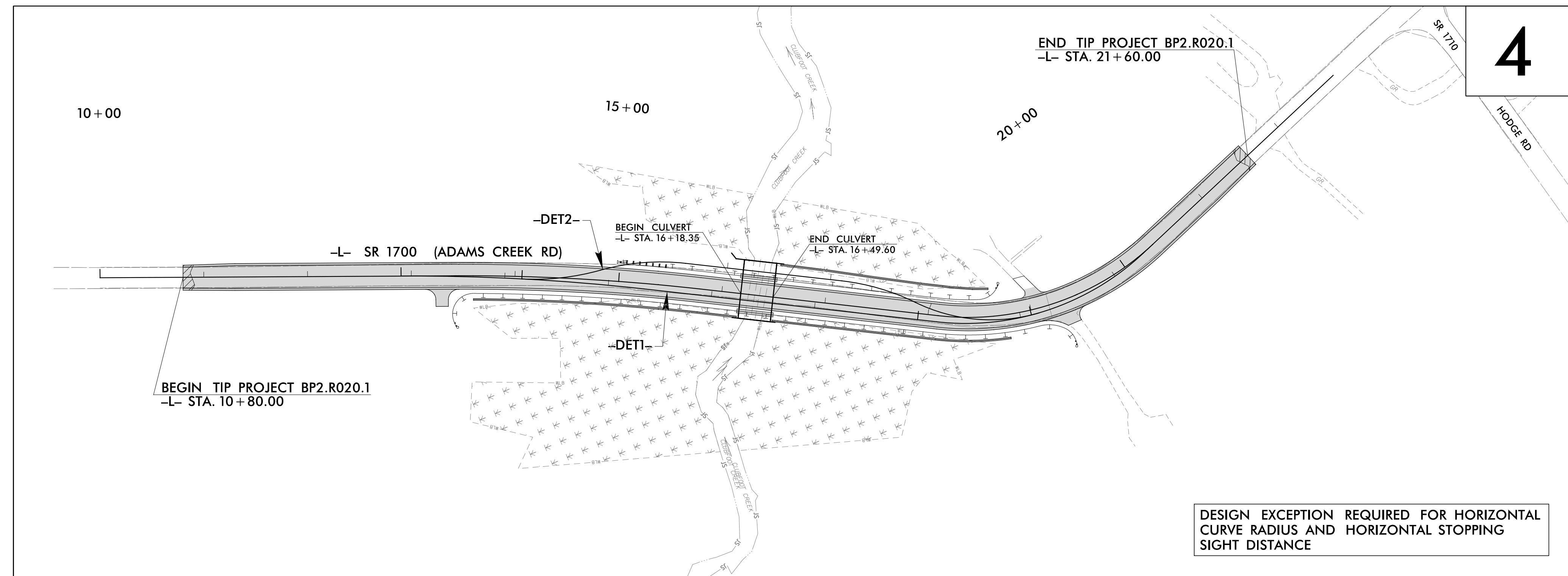
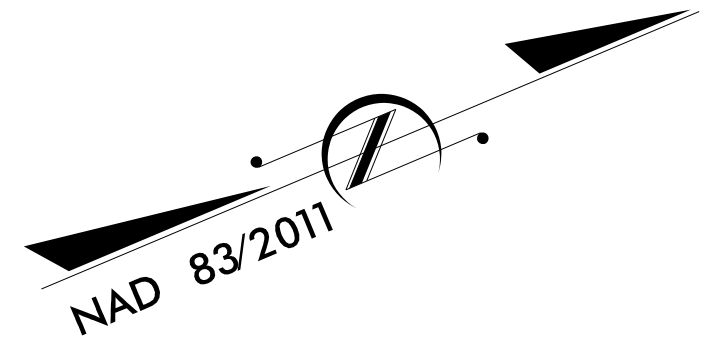

THERE IS NO CONTROL OF ACCESS ON THIS PROJECT.
THIS PROJECT IS NOT WITHIN MUNICIPAL BOUNDARIES.
CLEARING ON THIS PROJECT SHALL BE PERFORMED TO LIMITS ESTABLISHED BY METHOD II.

PRELIMINARY PLANS
DO NOT USE FOR CONSTRUCTION
DOCUMENT NOT CONSIDERED FINAL
UNLESS ALL SIGNATURES COMPLETED

CONTRACT:

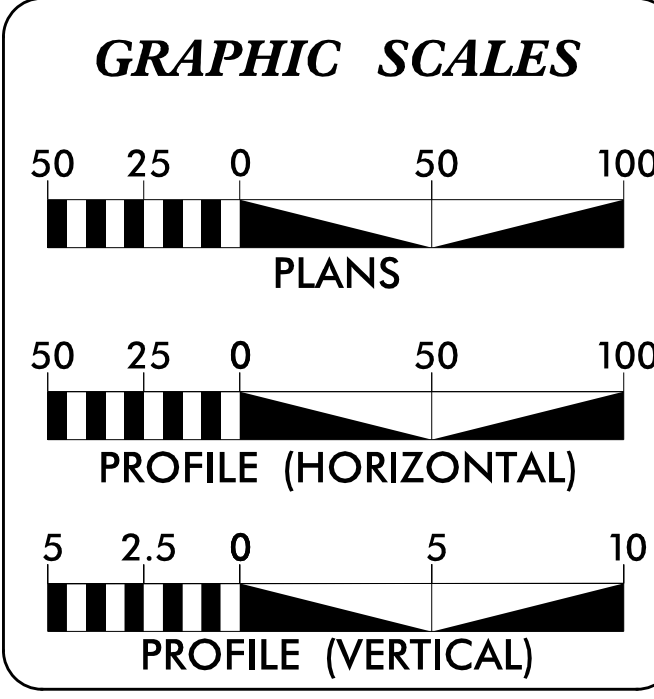

DESIGN DATA

ADT 2018 = 3,000
V = 50 MPH

FUNC CLASS =
MINOR COLLECTOR
SUBREGIONAL TIER

PROJECT LENGTH

LENGTH ROADWAY PROJECT BP2.R020.1 = 0.199 MILES
LENGTH STRUCTURE PROJECT BP2.R020.1 = 0.006 MILES
TOTAL LENGTH OF PROJECT BP2.R020.1 = 0.205 MILES

PLANS PREPARED BY: wood. 4021 STIRRUP CREEK DRIVE DURHAM, NC 27703 NC ENG. F-1253 2018 STANDARD SPECIFICATIONS	PLANS PREPARED FOR: DIVISION OF HIGHWAYS DIVISION 2 1037 W.H. SMITH BLVD. GREENVILLE, NC 27835
RIGHT OF WAY DATE: MAY 6, 2022	CHRISTOPHER H. LEE, PE PROJECT ENGINEER
LETTING DATE: AUGUST 24, 2022	MICHAEL AMAN, PE NCDOT CONTACT DIV 2 BRIDGE PROGRAM MANAGER

HYDRAULICS ENGINEER

SIGNATURE: _____ P.E.

ROADWAY DESIGN ENGINEER

SIGNATURE: _____ P.E.

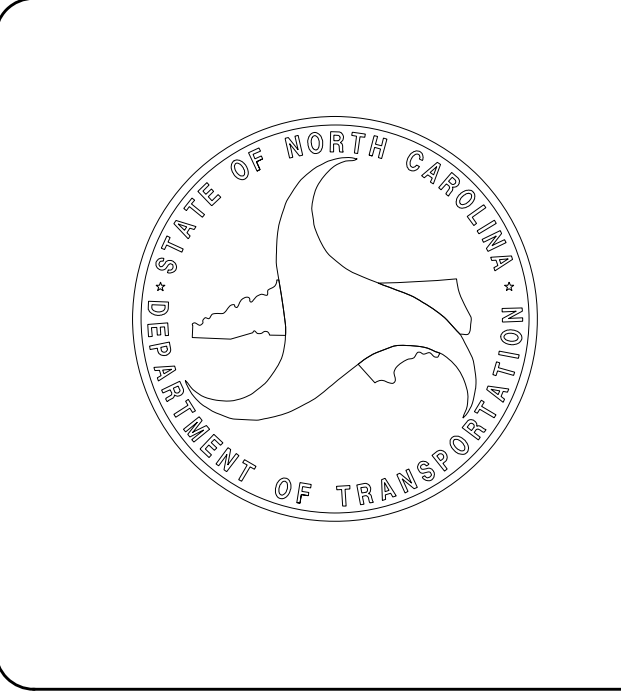

6/6/2022 BP2.R0201_RDY_TSH_buffer.dgn

**BUFFER DRAWING
SHEET 2 OF 3**

PROJECT REFERENCE NO. BP2.R020	SHEET NO. 4
RW SHEET NO.	
ROADWAY DESIGN ENGINEER	HYDRAULICS ENGINEER
PRELIMINARY PLANS DO NOT USE FOR CONSTRUCTION	
DOCUMENT NOT CONSIDERED FINAL UNLESS ALL SIGNATURES COMPLETED	

BUFFER ZONE	IMPACT	
	PERMANENT IMPACT	TEMPORARY IMPACT
ZONE A1	380sf(0.009ac)	820sf(0.019ac)
ZONE A2	112sf(0.003ac)	698sf(0.016ac)
ZONE B1	538sf(0.013ac)	
ZONE B2	183sf(0.004ac)	
ZONE C1	454sf(0.010ac)	865sf(0.020ac)
ZONE C2	413sf(0.009ac)	499sf(0.011ac)
ZONE D1	478sf(0.011ac)	
ZONE D2	89sf(0.002ac)	

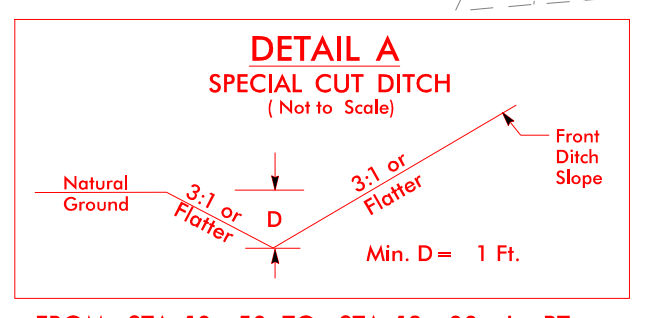
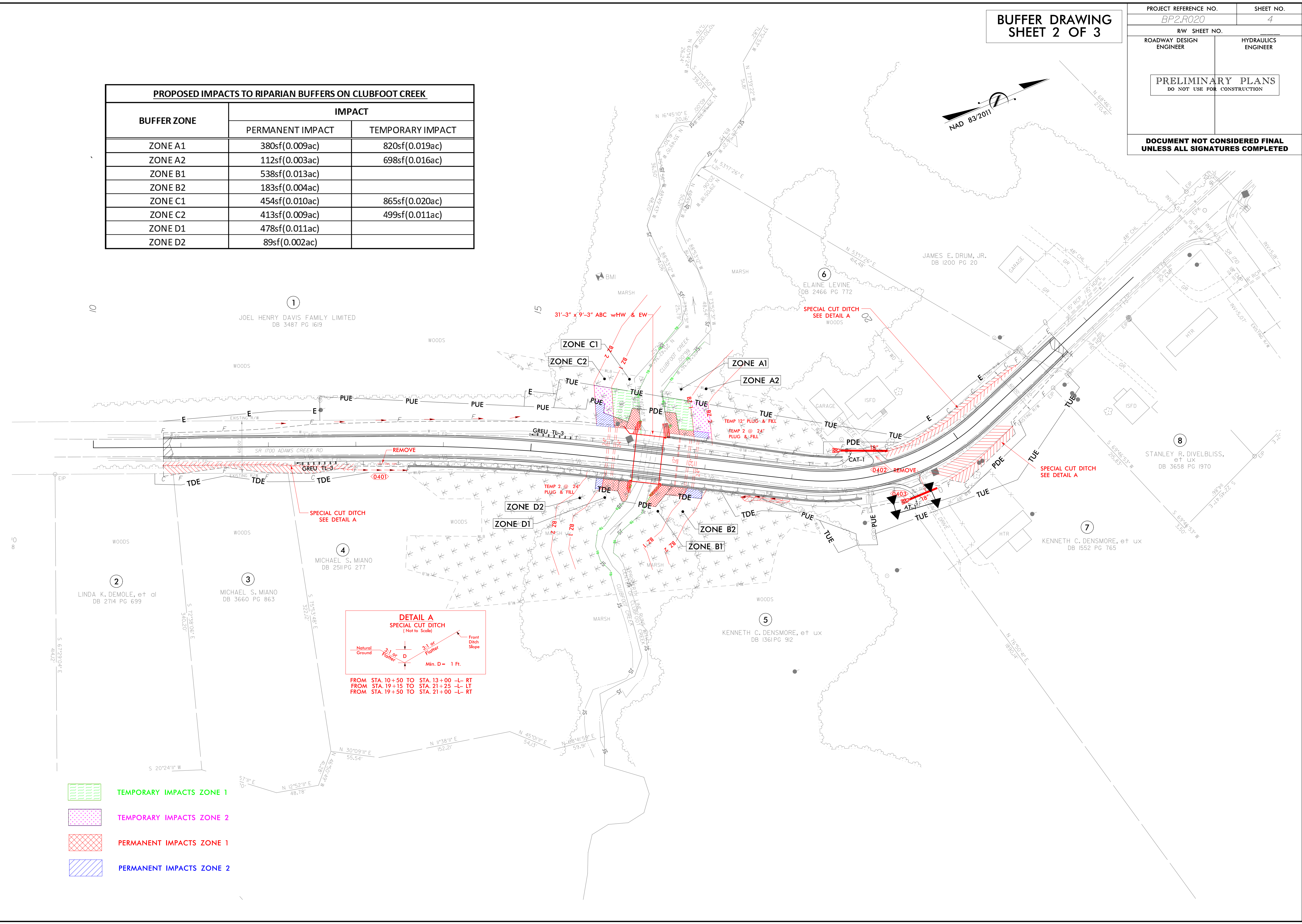

- TEMPORARY IMPACTS ZONE 1
- TEMPORARY IMPACTS ZONE 2
- PERMANENT IMPACTS ZONE 1
- PERMANENT IMPACTS ZONE 2

5/14/99
7/5/2020
BP2.R020
ROY.PSH_04_buffer.dgn
PLEASE

RIPARIAN BUFFER IMPACTS SUMMARY

Site No.	Station (From/To)	Structure Size / Type	IMPACTS									BUFFER REPLACEMENT			
			TYPE			ALLOWABLE			MITIGABLE			ZONE 1 (ft ²)	ZONE 2 (ft ²)		
			ROAD CROSSING	BRIDGE	PARALLEL IMPACT	ZONE 1 (ft ²)	ZONE 2 (ft ²)	TOTAL (ft ²)	ZONE 1 (ft ²)	ZONE 2 (ft ²)	TOTAL (ft ²)				
1	-L- 15+64 to 17+04	Culvert		X							3535	1994	5529		
TOTALS*:						0	0	0	3535	1994	5529	0	0		

NOTES:

NC DEPARTMENT OF TRANSPORTATION
 DIVISION OF HIGHWAYS
 June 6, 2022
 CRAVEN COUNTY
 BP2.R020